



The Conifers Portland Road, East Grinstead

East Grinstead

£625,000

A rare opportunity to acquire a substantial ground floor apartment on a sought after road within easy reach of the town centre offering spacious, versatile and well presented accommodation full of character features including sash windows, high ceilings and wooden flooring.

The accommodation comprises entrance hall, dining hall, impressive living room with wood burning stove, conservatory enjoying far reaching views, refitted kitchen/ breakfast room, large main bedroom with feature bay window, two further bedrooms/reception rooms, refitted bathroom, cloakroom and utility room.

Outside the property benefits from parking area, detached single garage and beautiful south facing garden enjoying far reaching views.

Viewings are highly recommended to appreciate the accommodation on offer and the property is offered to the market with no ongoing chain.

- Full of Character Features
- Sought After Location
- Spacious, Versatile & Superbly Presented Accommodation
- South Facing Rear Garden with Views
- Refitted Kitchen
- Refitted Bathroom
- Garage & Parking Area
- No Ongoing Chain

The property is situated in a sought after location. Local primary and secondary schools are within easy reach and the town centre is a short walk away and offers a comprehensive range of shopping, cinema, leisure centre, gyms, coffee shops, restaurants, public houses and three supermarkets.



COLE'S ESTATE AGENTS
Ref 10000

This plan is for layout guidance only.
Not drawn to scale, unless stated.
Windows and door openings are
approximate.

Whilst every care is taken in the
preparation of this plan, please check
all dimensions, shapes and compass
bearings before making any decisions
reliant upon them.

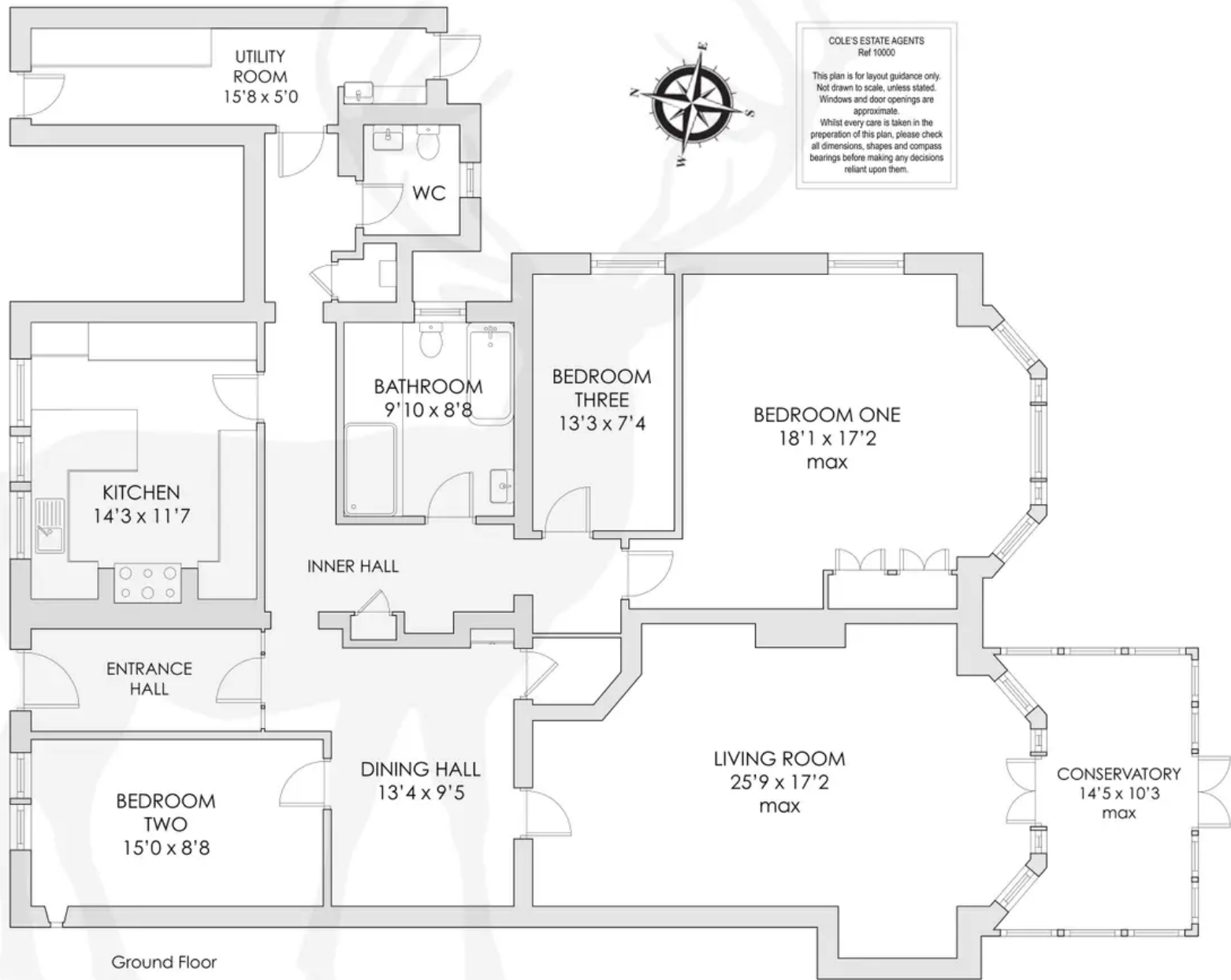

GARAGE
17'0 x 9'1

AGENTS NOTE:
The garage is not shown
in position or orientation
in relation to the main
dwelling.

Ground Floor

